

# **CT Autism Data: Identification, Services & Transition**

**Alice Ridgeway  
Part C Coordinator  
CT Birth to Three**

---

1766

To the Right Honourable  
THE  
Earl of Shelburne  
His Majesty's Principal  
SECRETARY OF STATE  
for the Southern Department  
This PLAN of the COLONY of CONNECTICUT in  
NORTH-AMERICA  
Is Humbly Dedicated by his Lordship's  
Most Obedient Humble Servant,  
Nov. 24. 1766. Moses Park.

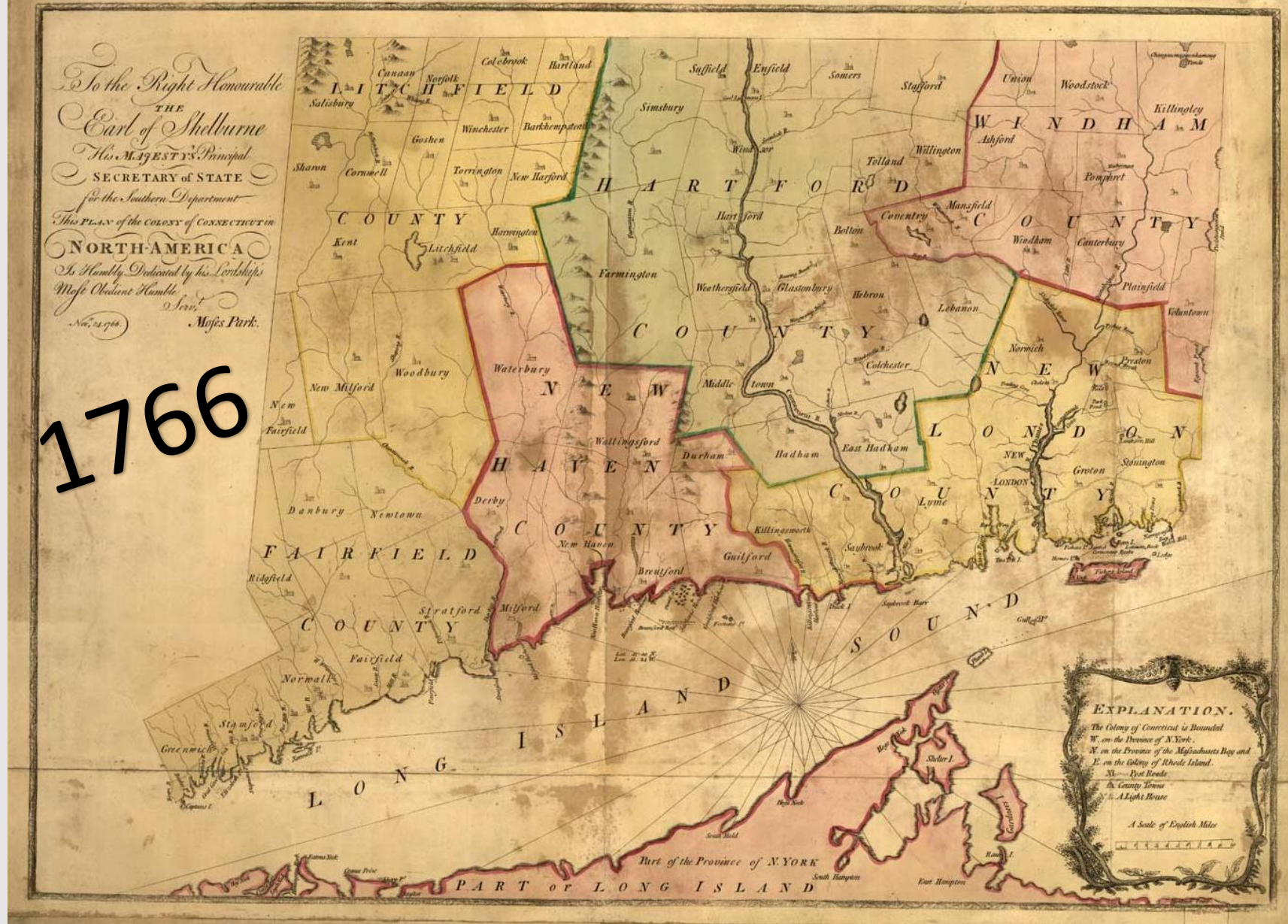



Lead Agency du Jour  
Office of Early Childhood

# Connecticut 101



32 programs at  
29 agencies

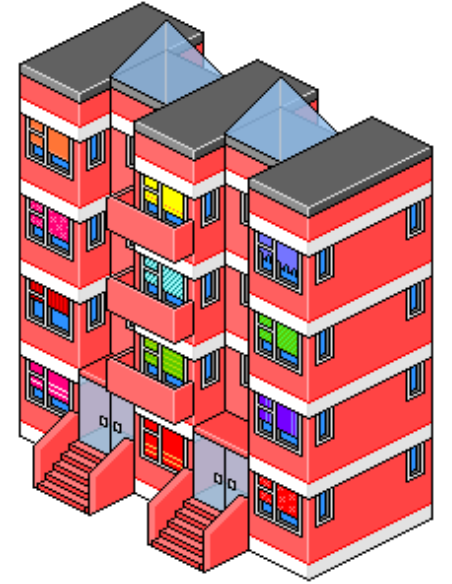

Currently 3 “types”  
~General  
~Autism Specific  
~Hearing Specialty

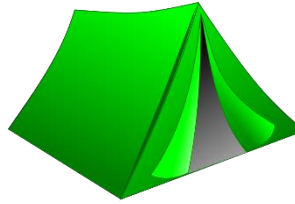



Connecticut







# CT B23 System and Autism Timeline

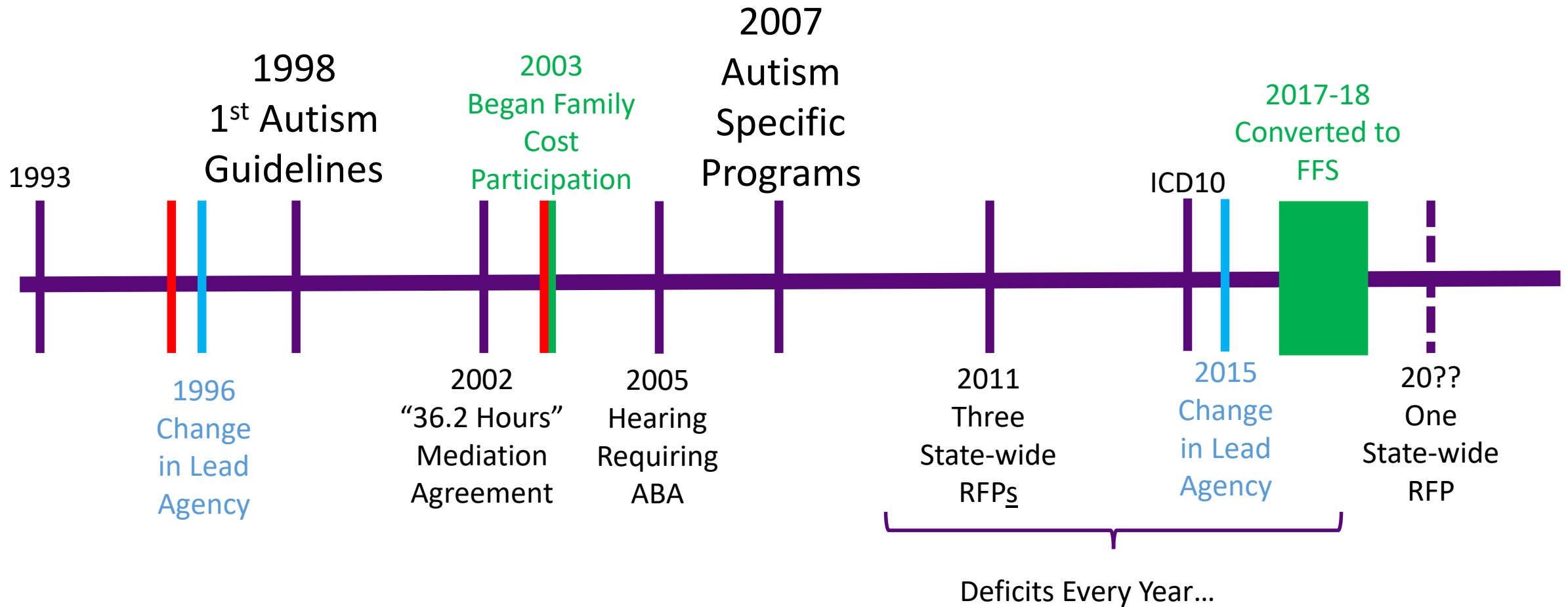





Medicaid-EPSDT  
Birth to Three  
SPA  
\$14M

State  
Part C Funds  
to OEC  
\$21M

State Match  
\$14M

Part C Grant  
\$4M

Commercial  
Insurance  
\$2M...?

Part B  
Grant  
\$1M

Family Cost  
Participation Fees  
\$4M

# 2014 Birth Cohort



1/1/14 ————— 12/31/14

Turned 3 by 12/31/17



IFSP ICD = Autism  
675

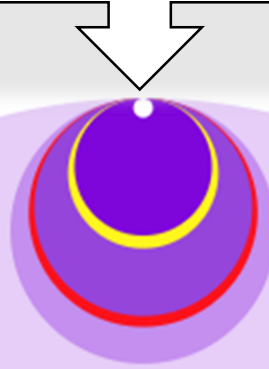

2014 Birth Cohort  
Census Estimate  
38,761

1.74%    1:54

# Racial /Ethnic Percentages

■ Hsp ■ nHsp ■ WHsp ■ WnHsp ■ nWHsp ■ nWnHsp

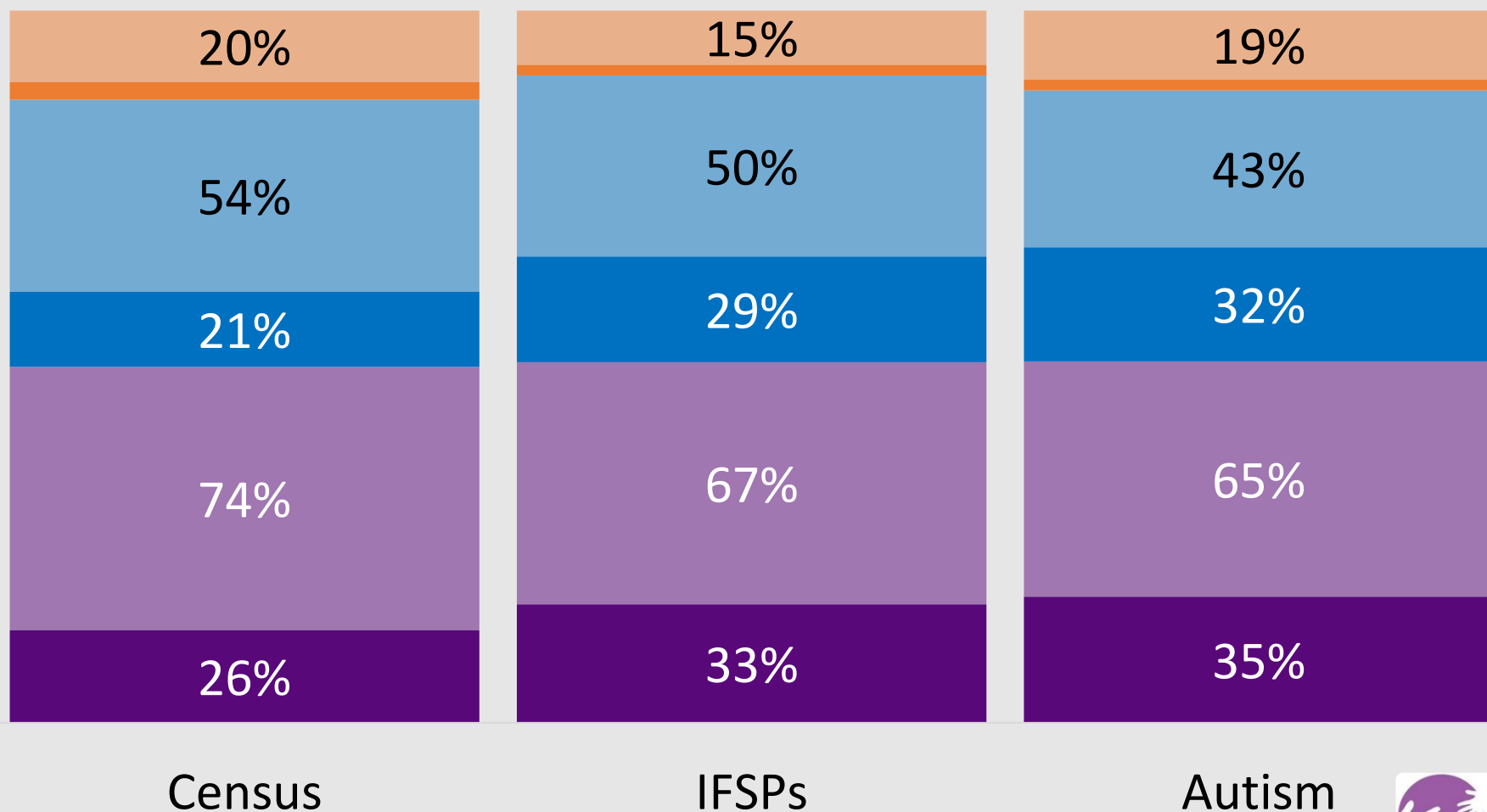

# Insurance Type

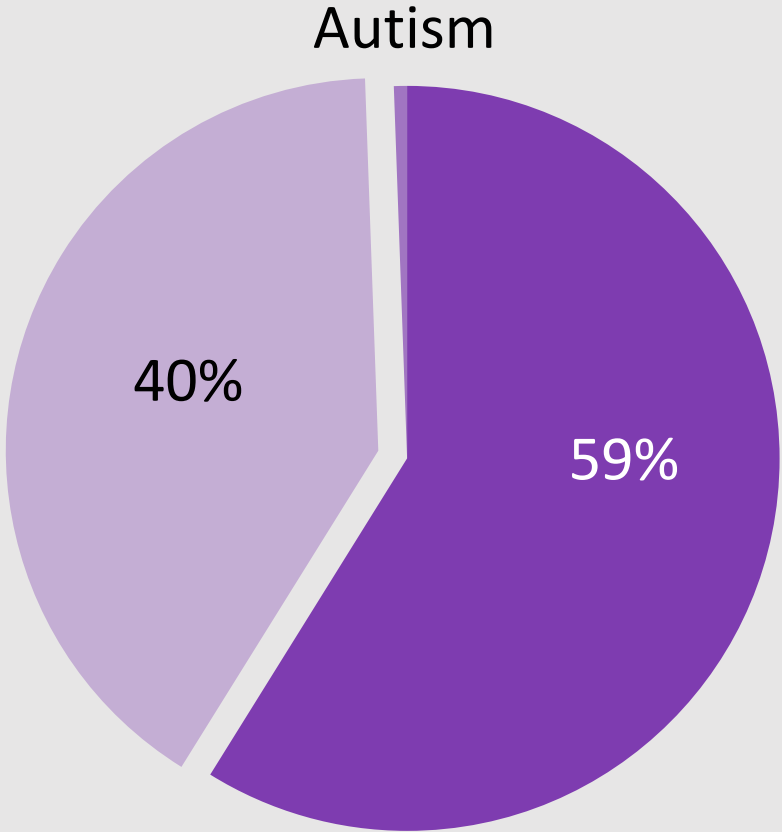
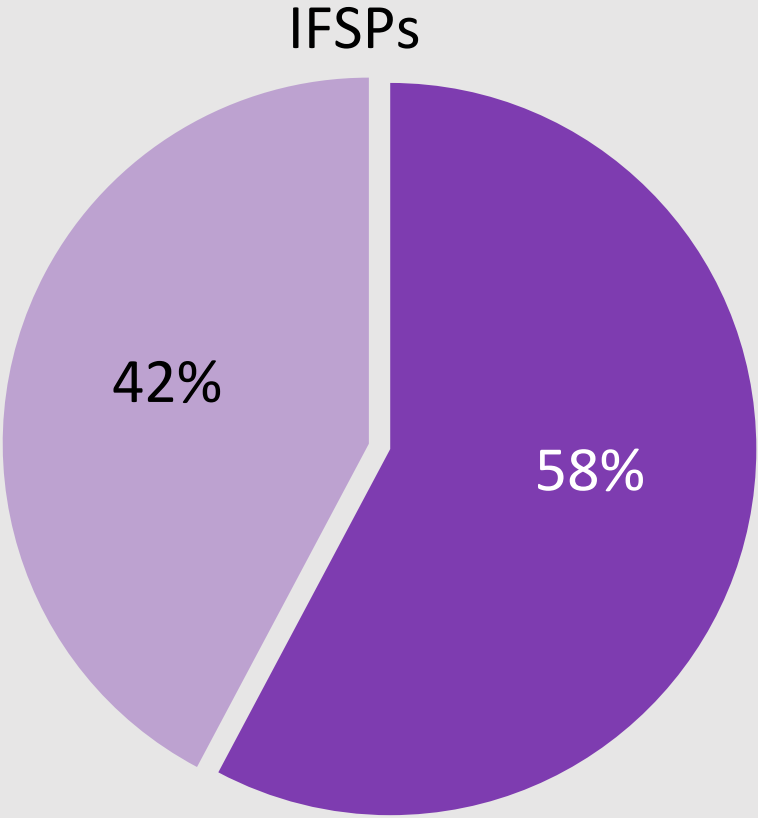

■ Medicaid

■ Commercial

■ Unk



# Commercial Insurance Income Levels

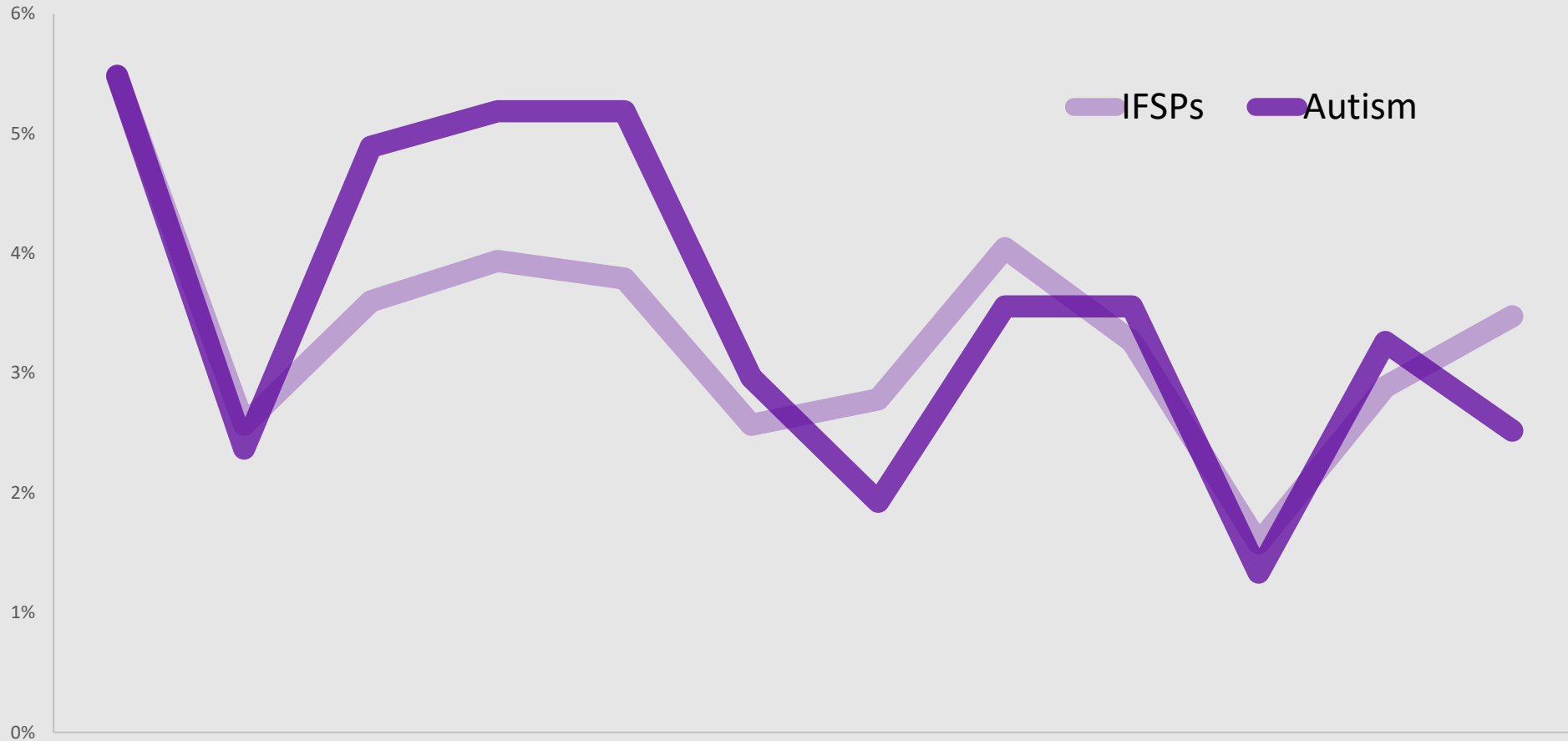

# Home Language

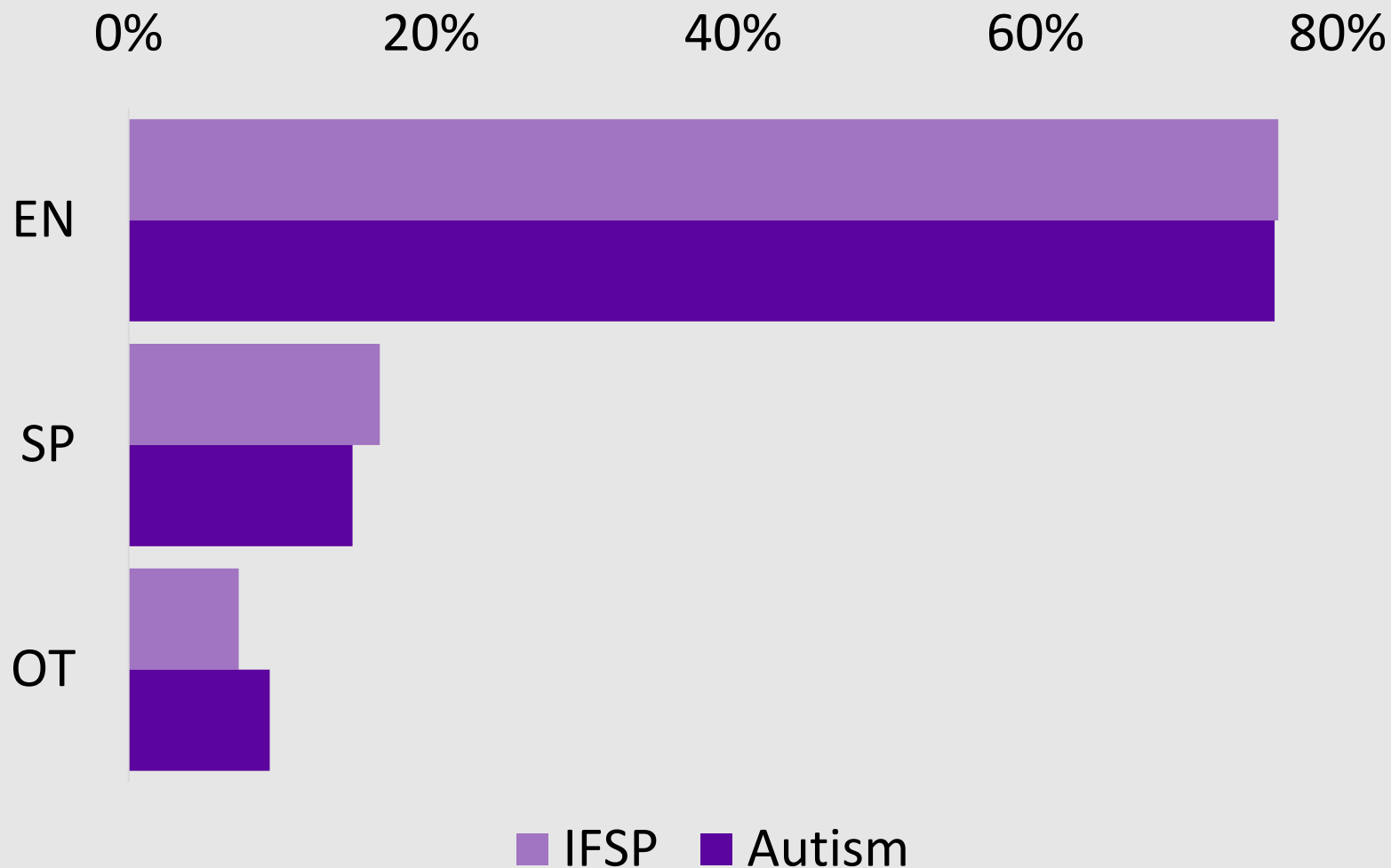

# Referral Concerns

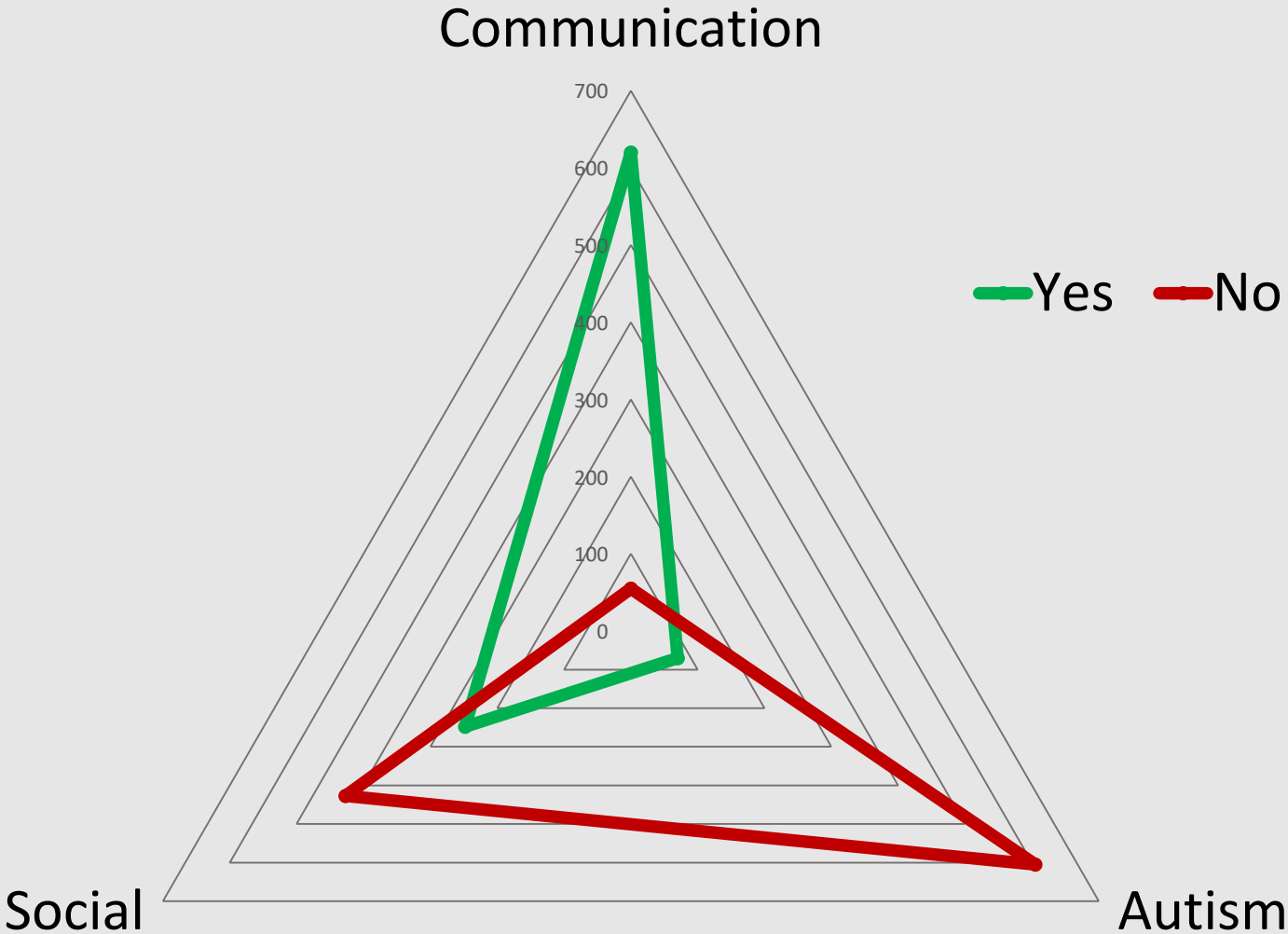



# Average Age At Referral



# Average Age when 1<sup>st</sup> IFSP Includes an Autism ICD

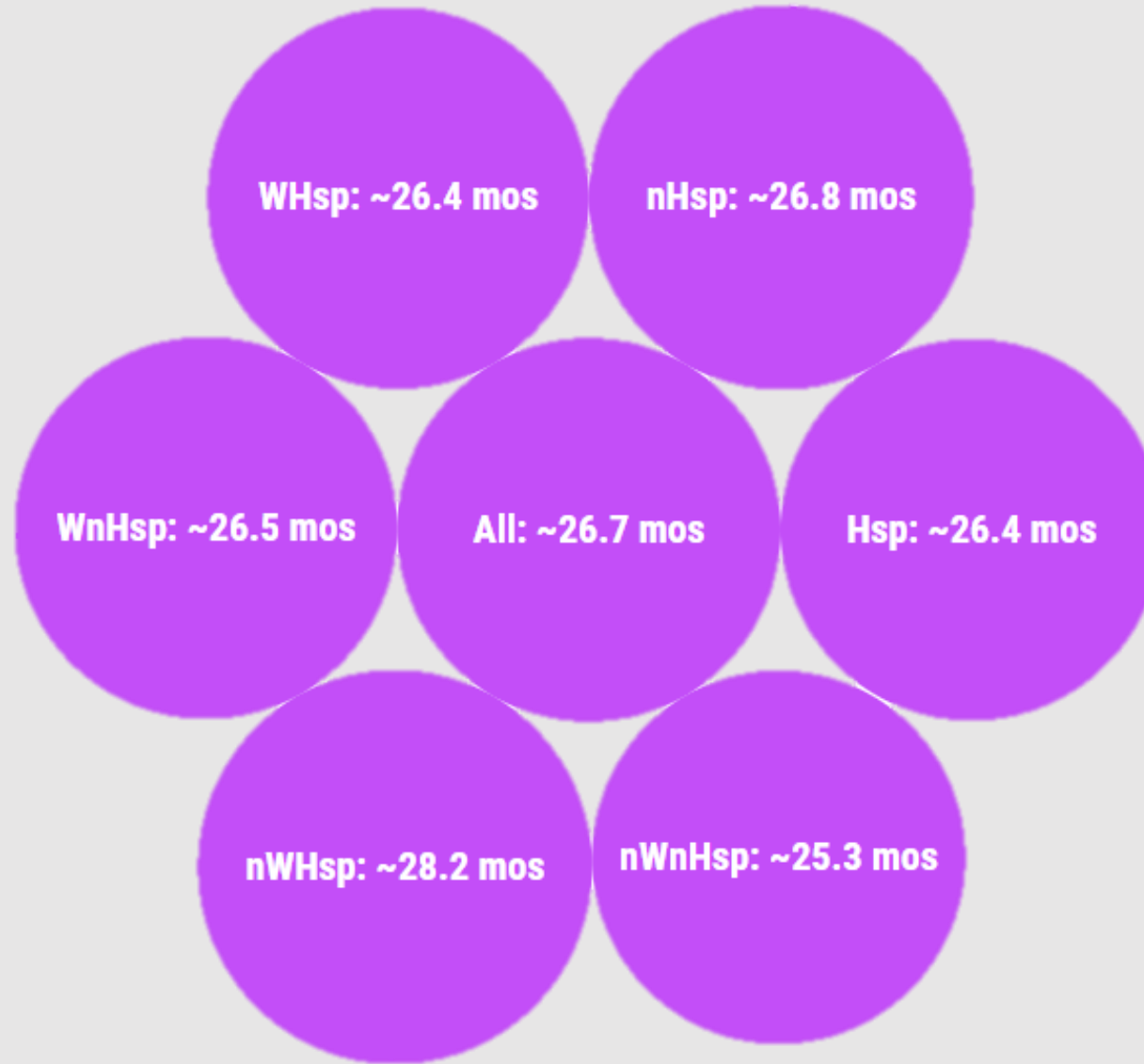

# Average Hours pm on 1<sup>st</sup> “autism” IFSP

Mean = 38.4

Median = 36.1

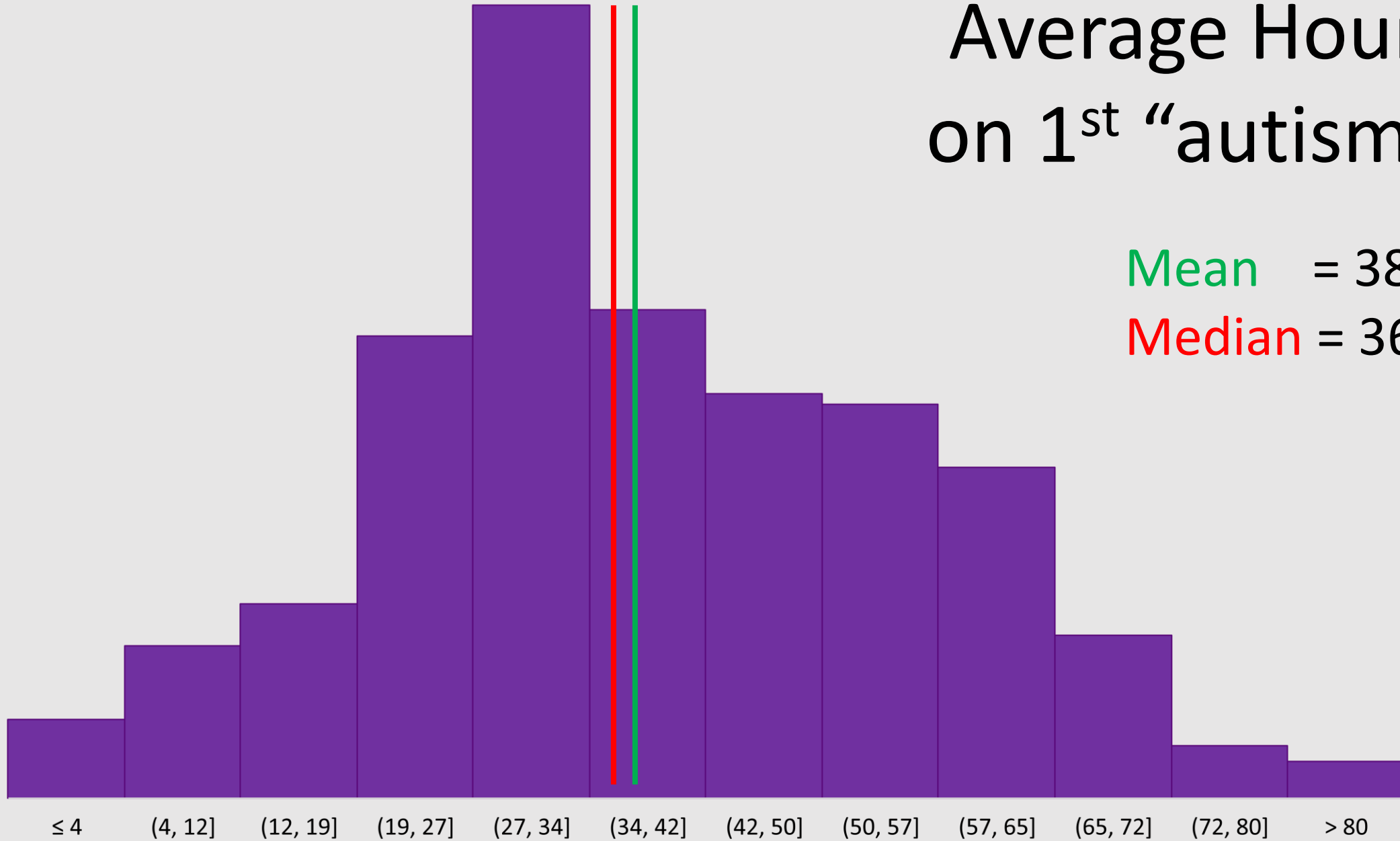



# Average Hours pm on Last IFSP

Mean = 40.5

Median = 37.2

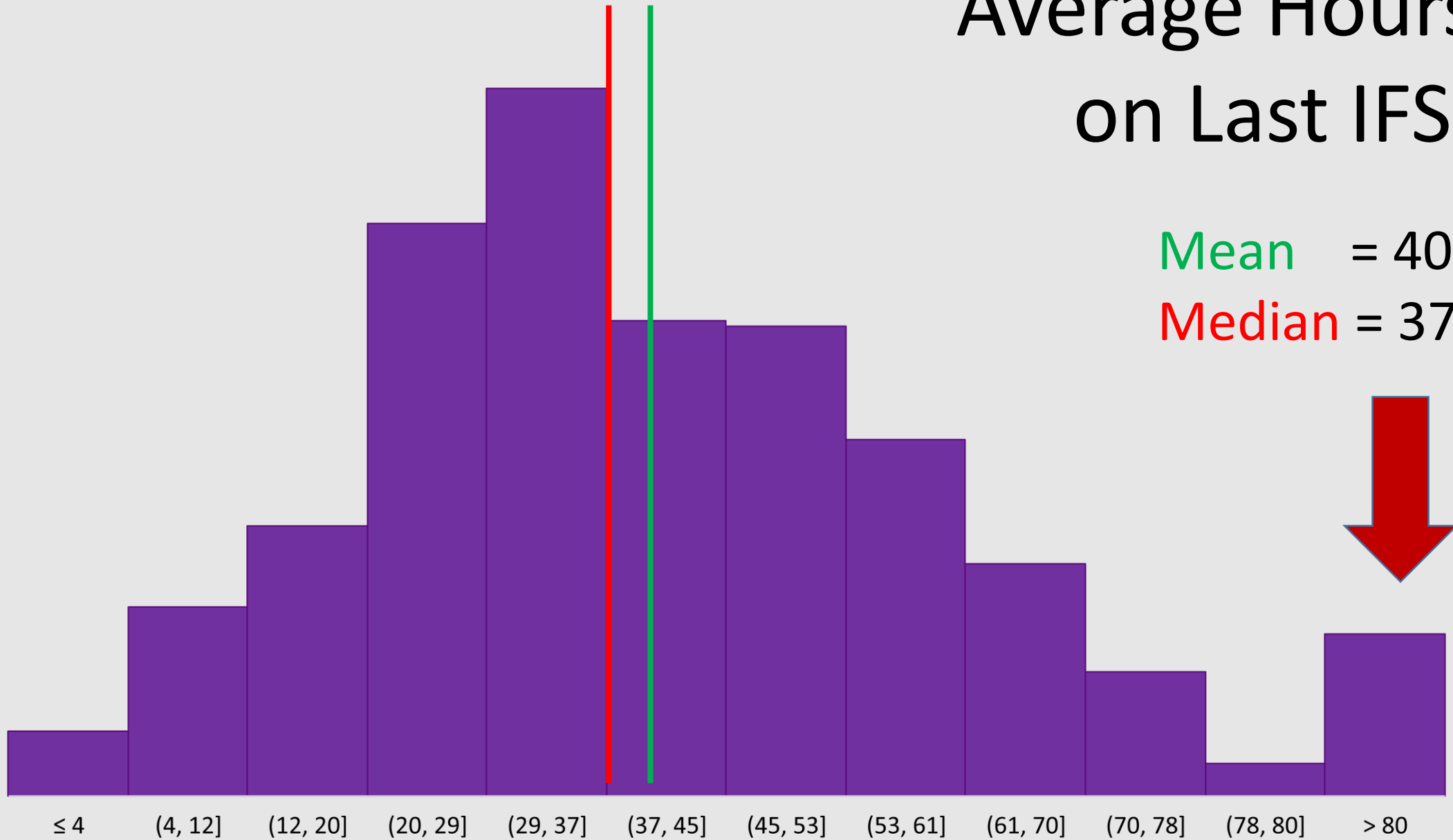

# Average Hours Delivered During First Full Month (after Dx)

Mean = 29.5

Median = 27.5

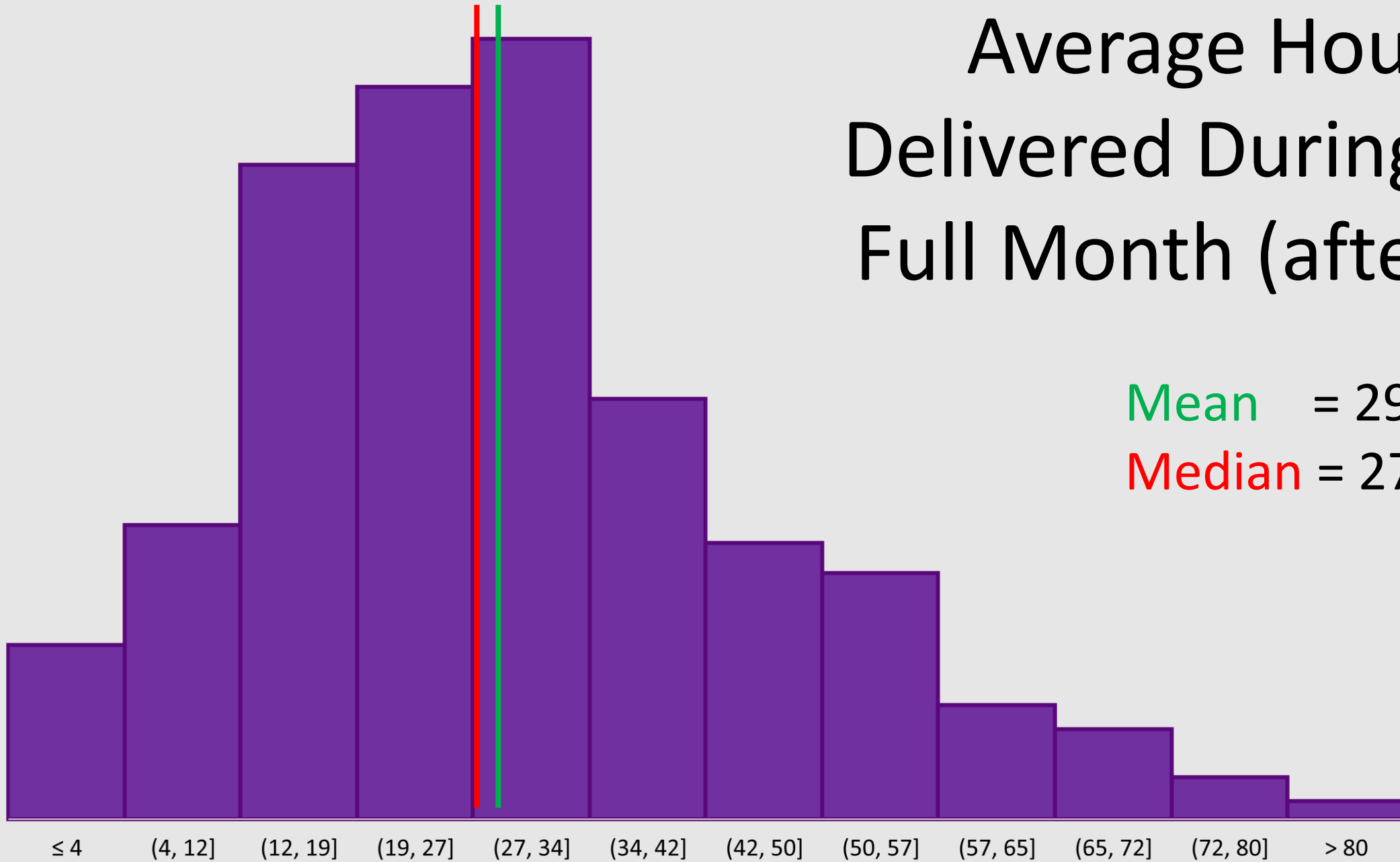

# Average Hours Delivered During Last Month Before Exit

Mean = 35.7

Median = 32.3

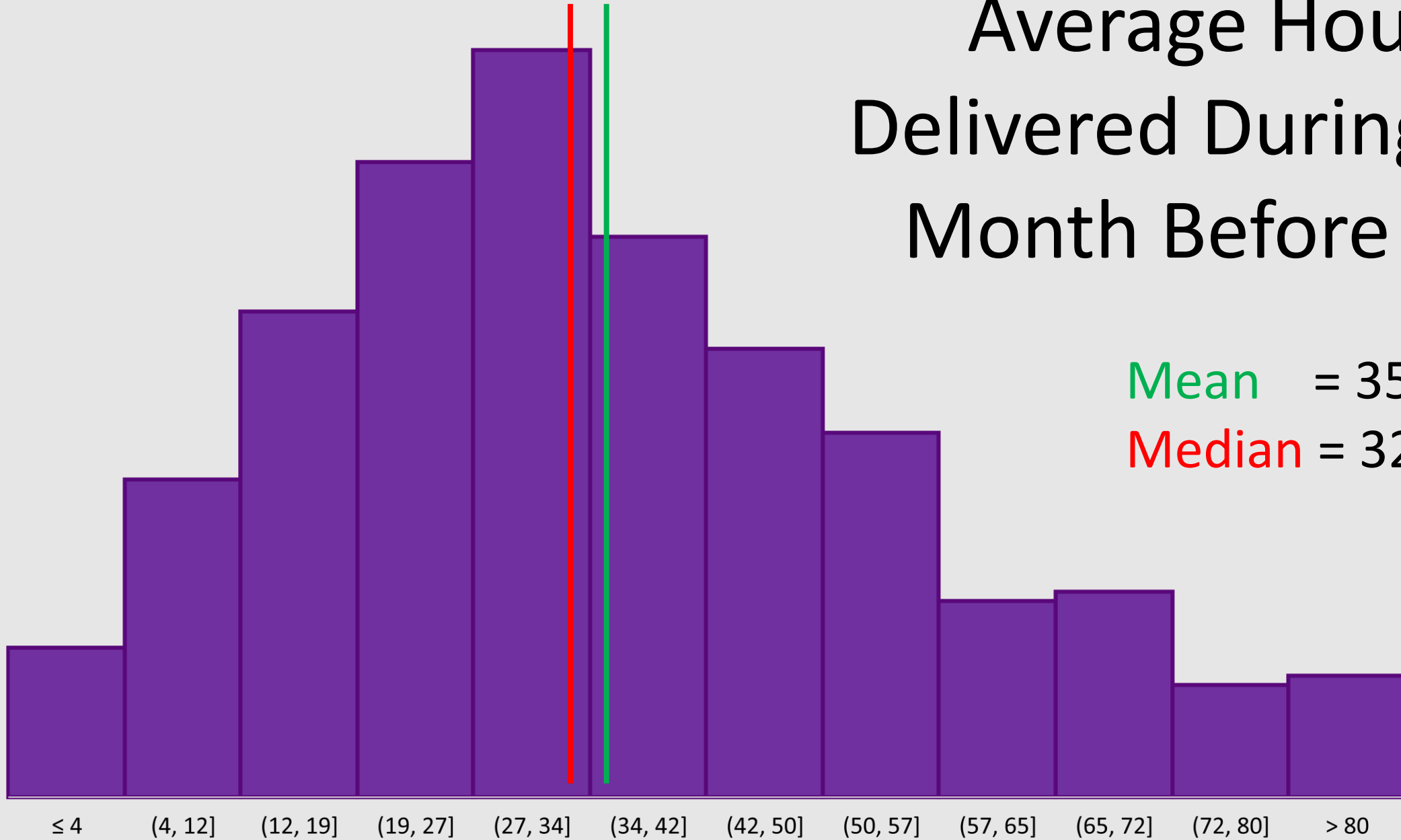

# Almost All Visit Occur at Home or Child Care

19 of the 675 had EIS  
only in Child Care or  
a Community setting

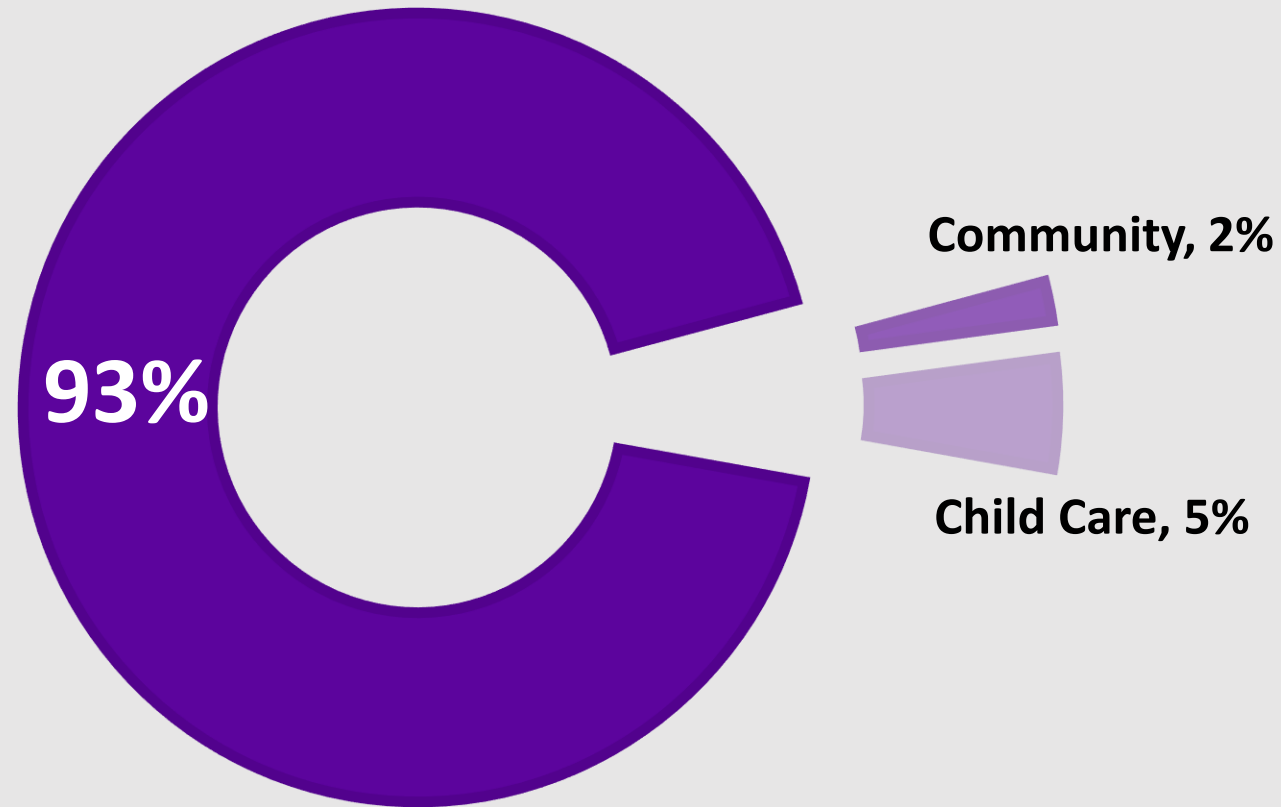



# Reasons for Exiting

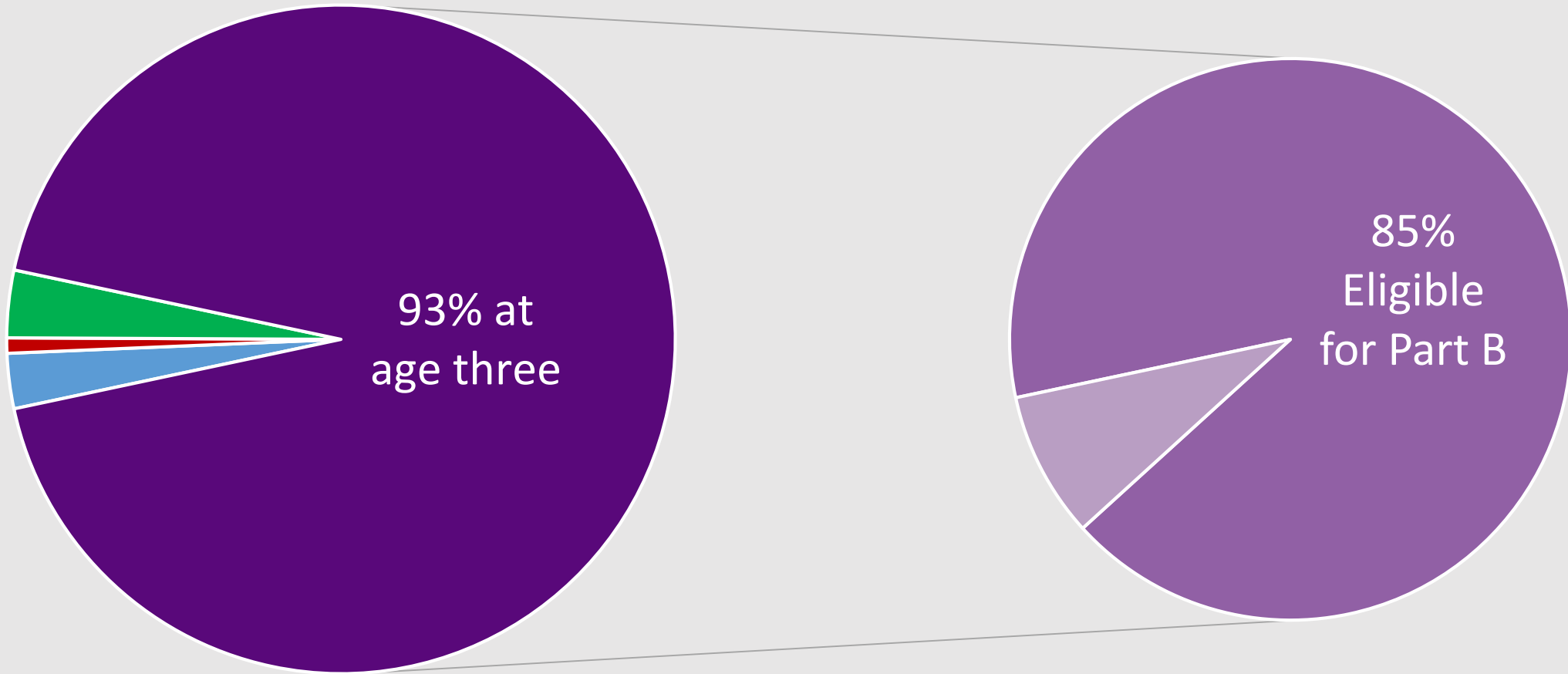

■ Withdrawn by Parent ■ Unable to contact ■ Moved ■ Eligible Part B ■ Exit at 3 other

# Autism as Primary Disability Category on IEPs

| IEP 10/1     | Age  |      |      |      |      |      |
|--------------|------|------|------|------|------|------|
|              | 3    | 4    | 5    | 6    | 7    | 8    |
| <b>2010</b>  | 223  | 224  | 316  | 452  | 514  | 501  |
| <b>2011</b>  | 172  | 284  | 332  | 511  | 496  | 541  |
| <b>2012</b>  | 193  | 231  | 375  | 515  | 557  | 544  |
| <b>2013</b>  | 204  | 261  | 331  | 536  | 556  | 558  |
| <b>2014</b>  | 236  | 276  | 370  | 565  | 576  | 583  |
| <b>2015</b>  | 271  | 307  | 393  | 567  | 616  | 598  |
| <b>2016</b>  | 295  | 330  | 436  | 596  | 646  | 642  |
| <b>2017</b>  | 338  | 394  | 465  | 690  | 652  | 676  |
| <b>Total</b> | 2352 | 2910 | 3899 | 5717 | 5903 | 5942 |

Percent of  
38,000  
(ROUGH census)

[illegible]

48% of Children  
Born in 2014,  
Diagnosed with  
Autism in Part C,  
and Exiting as  
Eligible for Part B  
(*before 10/1/14*)  
had Autism as the  
Primary Disability on  
their IEP

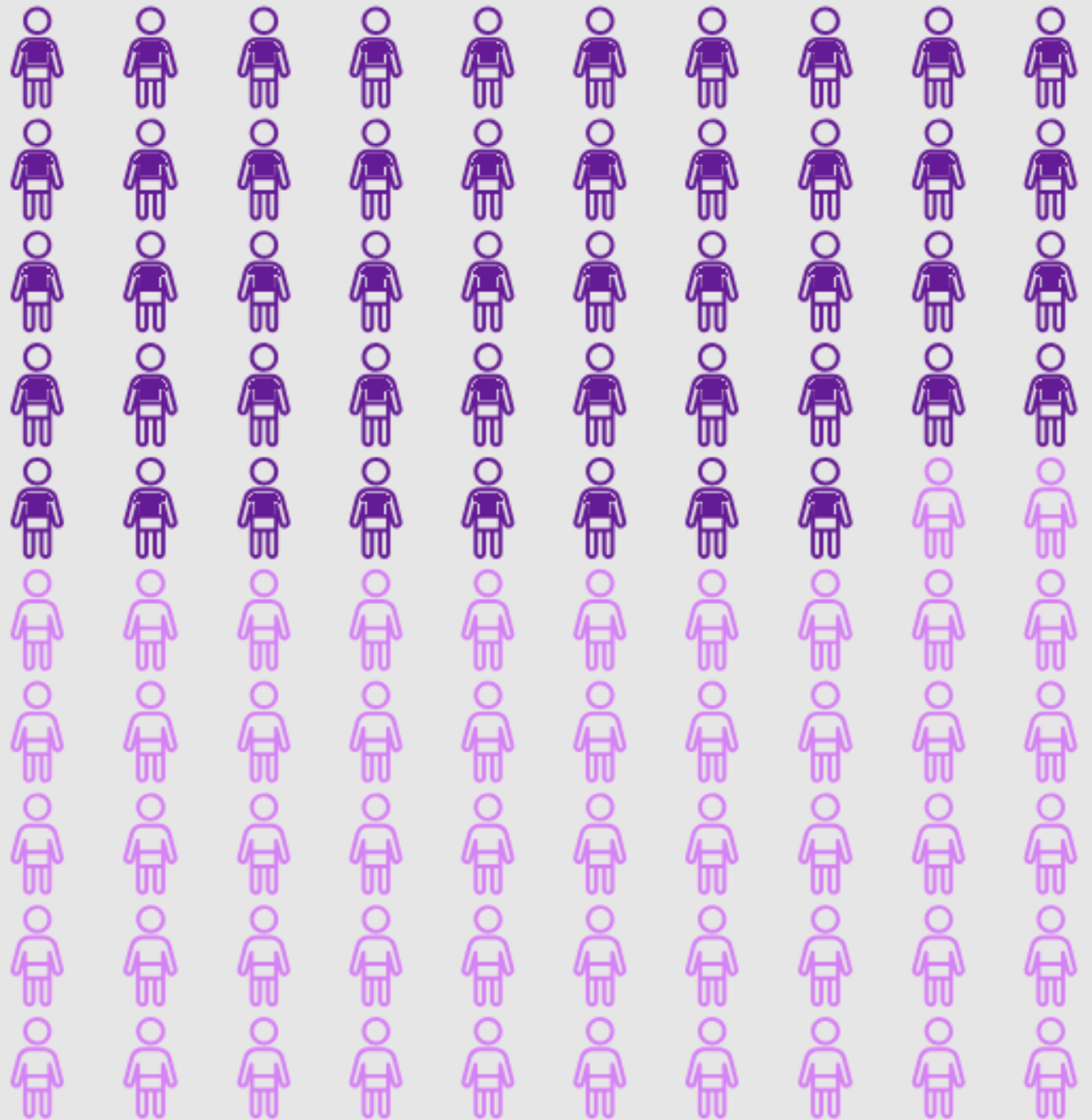



[Alice.Ridgway@ct.gov](mailto:Alice.Ridgway@ct.gov)



Connecticut Office of  
**Early Childhood**